

Combi-Cam MOUNTING CUTOUT

Installation Instructions:

- Fits standard 3/4" cam hole
- Short cam can be placed in increments of 90 degree positions
- Long cam can be positioned in increments of 45 degrees

1. Insert lock body through front of 3/4" drilled hole.
2. Wood Only- place prong washer over lock body, prongs facing wood.
3. Thread cylinder nut & tighten.
4. Attached stop cam and straight cam and secure with screw and lock washer.

Note: Stop cam placement

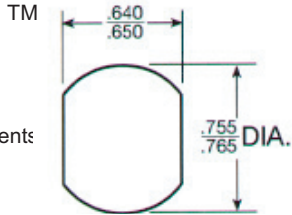

Instructions for setting your personal combination:

- The combination is factory set at >>0-0-0<<
- Combination must be on opening number prior to resetting
- On the underside outer edge of the lock there is hole for the code reset button. Rotate the face of cam until the code reset button comes into view.
- Push this pin in with a paper clip and keep it pushed in.
- Set your personal combination by turning the dials to the desired combination.
- Release the reset button and your combination is set.
- To lock, rotate lock to "locked" position. Rotate one or more dials after lock is closed. To open the lock, turn dials to your personal combination.

NOTE: If you desire, the Combi-Cam can be installed such that it is nonresettable by the end-user.

Directions:

- Take off the screw to the cam and remove the cam & the "stop cam"
- Rotate the cylinder 180 degrees and then put the "stop cam" and the cam back on. © Frank J. Martin Co.

Combi-Cam
Division of
FJM Security Products

800-654-1786
Fax (206)-523-9876
www.combi-cam.com

18424 HWY 99
Lynnwood, WA 98037